

BARRIER KERB & CHANNEL SD 401

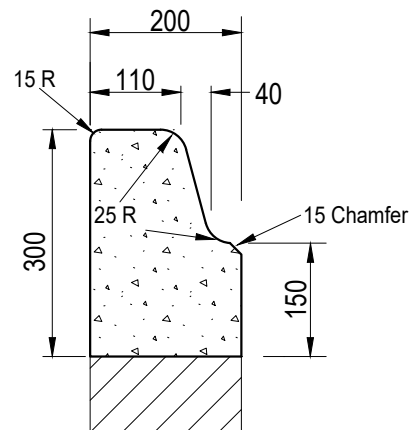

BARRIER KERB SD 402
(VicRds B1 kerb)

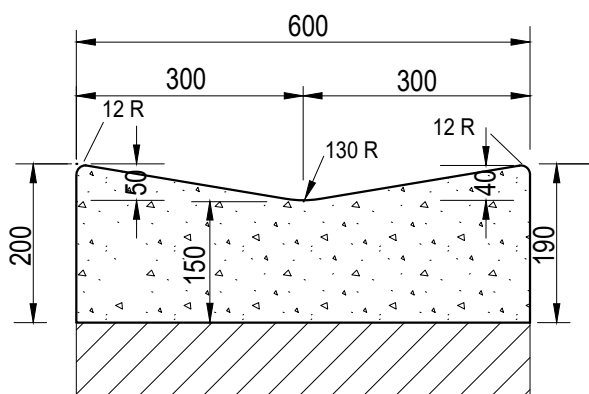

OPEN INVERT SD 403
(VicRds M2 kerb)

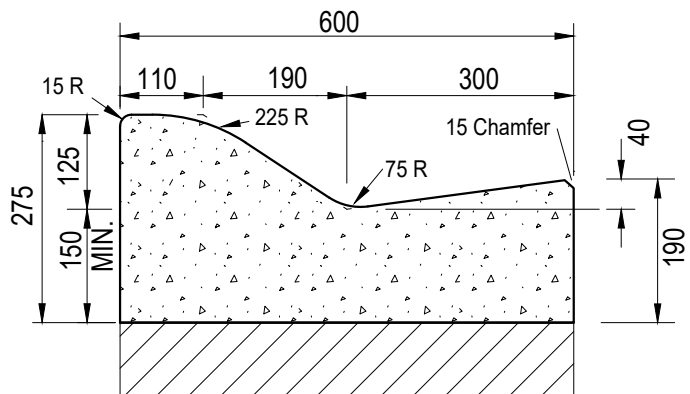

**SEMI-MOUNTABLE KERB
& CHANNEL SD 404** (VicRds SM2 kerb)
Layback required for vehicle crossings.

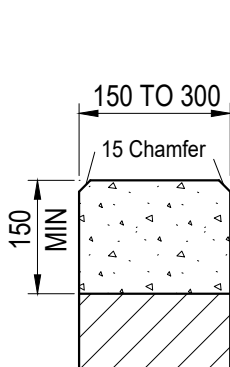

**CONCRETE EDGE
STRIP SD 405**

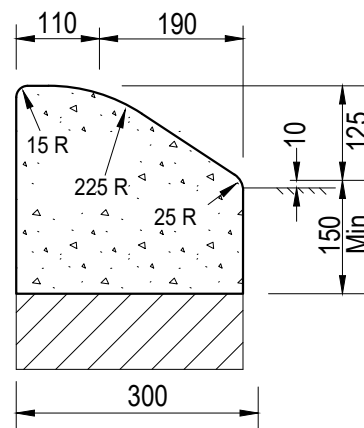

**SEMI-MOUNTABLE
KERB SD 406**
(VicRds SM1 kerb)

NOTES:

1. Joint spacing at 3m centres.
2. All profiles on a bedding of 20 mm Class 2 fine crushed rock, min. depth 75 mm.
3. Concrete strength to be 25MPa. at 28 days.
4. Transition from one kerb profile to another should take place over a 5m length.
5. Plastic Fibre mesh additive to be used in median and splitter island kerbs in accordance with manufacturer recommendations.



SCALE: 1:10

DATE: Dec 2012

APPROVED:

Addy.

DRAWN: S.R / P.J.D

CHECKED: T.T

MANAGER ENGINEERING SERVICES

LAST AMENDED: Dec 2025

KERB PROFILES

SD 401 - 406

PAGE 1 OF 1